

SULLIVAN, DANIEL P
 SULLIVAN, WANDA H
 335 TWIN LAKES DR
 HIGHLANDS, NC 28741-7719
 ACCOUNT NUMBER: 192854

Jackson County, North Carolina

Parcel: 7560751668
 Tax Year: 2024
 Reval Year: 2021
 Appraised By: JEM on 12/04/2023
 Information Source: O - Owner

Tax Districts
 General County Tax, Cashiers Fire Tax

PARCEL INFORMATION	PROPERTY DESCRIPTION	VALUE SUMMARY
Address: 335 TWIN LAKES DR	LT 10 HOLLY BERRY 1.2300 AC	LAND: 75,000
Neighborhood: 07039 - Holly Berry Mountain		BUILDING: 324,350
Road Type: R - Paved Private	PERMIT INFORMATION	OBXF: 4,500
Township: 07 - CASHIERS	Code Date Permit # Amount	MARKET VALUE: 403,850
Utilities: S-1, W-1		DEFERRED AMOUNT: 0
View: LF - Lake Front		EXEMPT VALUE: 0
NOTES	SALES INFORMATION	NET TAXABLE: 403,850
	Date Sales Price Valid Book/Page	
	2/6/2023 975,000 Y 2350/1555	
	4/17/2018 377,000 Y 2212/39	
	10/10/2002 N 1166/704	
	12/27/2000 260,000 N 1106/896	
	Plat Book: Plat Card:	

LAND DATA - MARKET VALUE												
MTH	CODE	DESCRIPTION	ZONING	PRICE PER ACRE	ACRES	ADJ 1	ADJ 2	ADJ 3	UTILITIES	VALUE	NOTES	
1	L	0140 Res Lakefront		75,000	1.000					75,000		
Total Acres:					1.000	Total Land Value:				75,000		

OUTBUILDING DATA															
CODE	DESC	CT	LN	WD	UNITS	GRADE	AYB	EYB	COND	PHYS	FUNC	ECON	% Cmpl	TAX VALUE	NOTES
16	CARPORT, AVG QUAL		24	20	480	C	1979	1979	A					4500	CARPORT

BUILDING DESCRIPTION	
VALUATION METHOD:	R - Residential
USE CODE:	R01 - SINGLE FAM DWLG
STYLE:	
FOUNDATION:	C - Continuous Wall
EXTERIOR WALL 1:	FR - Frame
EXTERIOR WALL 2:	
ROOF STRUCTURE:	G - Gable
ROOF COVER:	AS - Asphalt Shingle
BEDROOMS:	3
FULL BATHS:	3
HALF BATHS:	1
ADDITIONAL FIXTURES:	0
FIREPLACE TYPE/CNT/OPN/CH:	SD/1/2/1
ELEVATOR TYPE/COUNT/STOPS:	
PHYS OVERRIDE:	
ECONOMIC DEPRECIATION:	
FUNCTIONAL DEPRECIATION:	
SPECIAL CONDITION CODE:	
SPECIAL CONDITION VALUE:	
DESCRIPTION:	
REMARKS:	
HEATED SQUARE FEET:	2,176

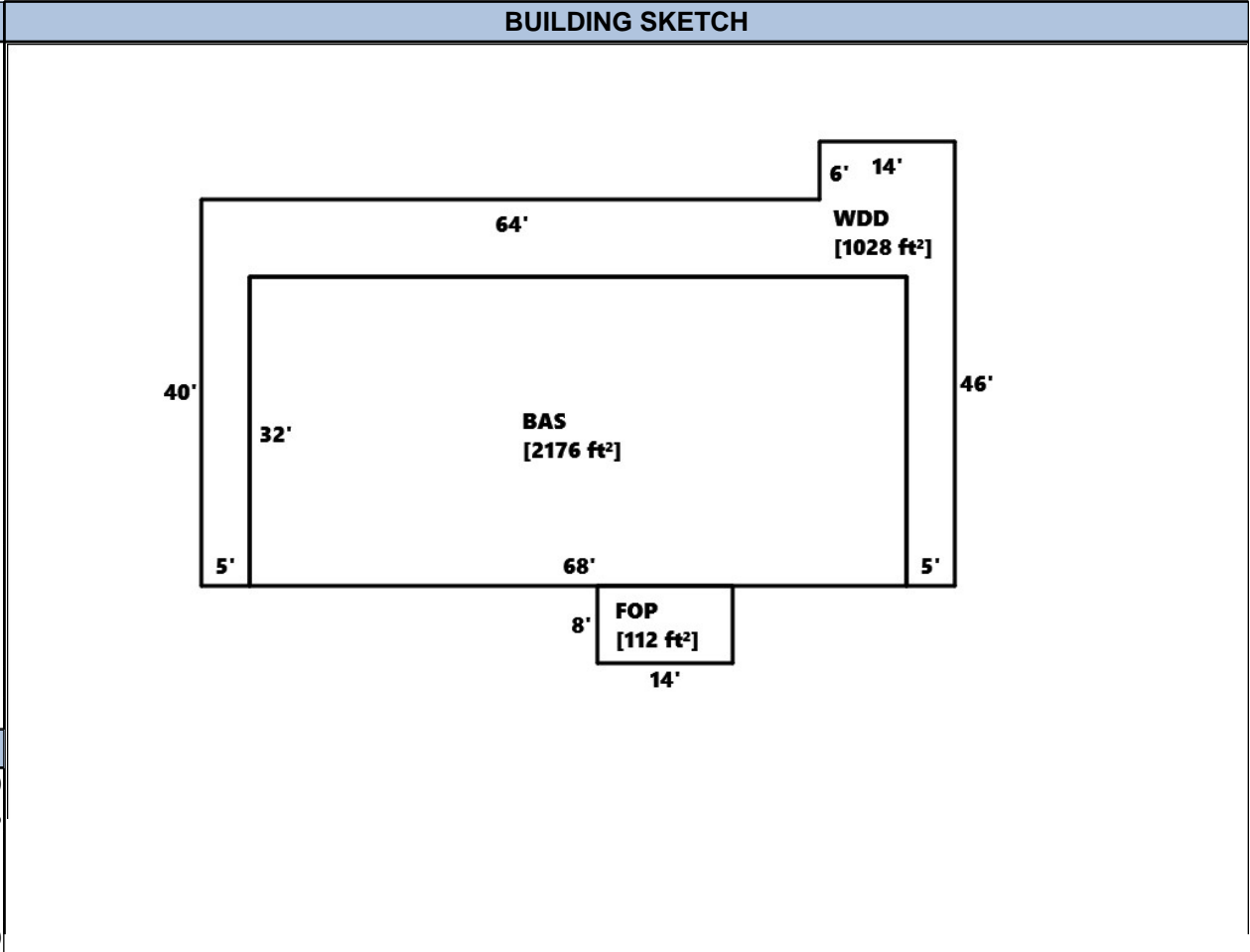

BUILDING SECTION DETAIL															
TYPE	AREA	Wall Ht	#ST	HEAT TYPE	HEAT%	AIR%	SPK%	GRADE	AYB	EYB	COND	P%	E%	F%	VALUE
BAS	2176	8.00	1.0	HP		100%		B	1967	1982	A	55%			231,589
FOP	112		1.0									55%			3,031
LLF	2144		1.0									55%			98,478
PTO	544		1.0									55%			2,453
WDD	1028		1.0									55%			13,921